

PORTERVILLE COLLEGE

Safety & Emergency Services Campus Map

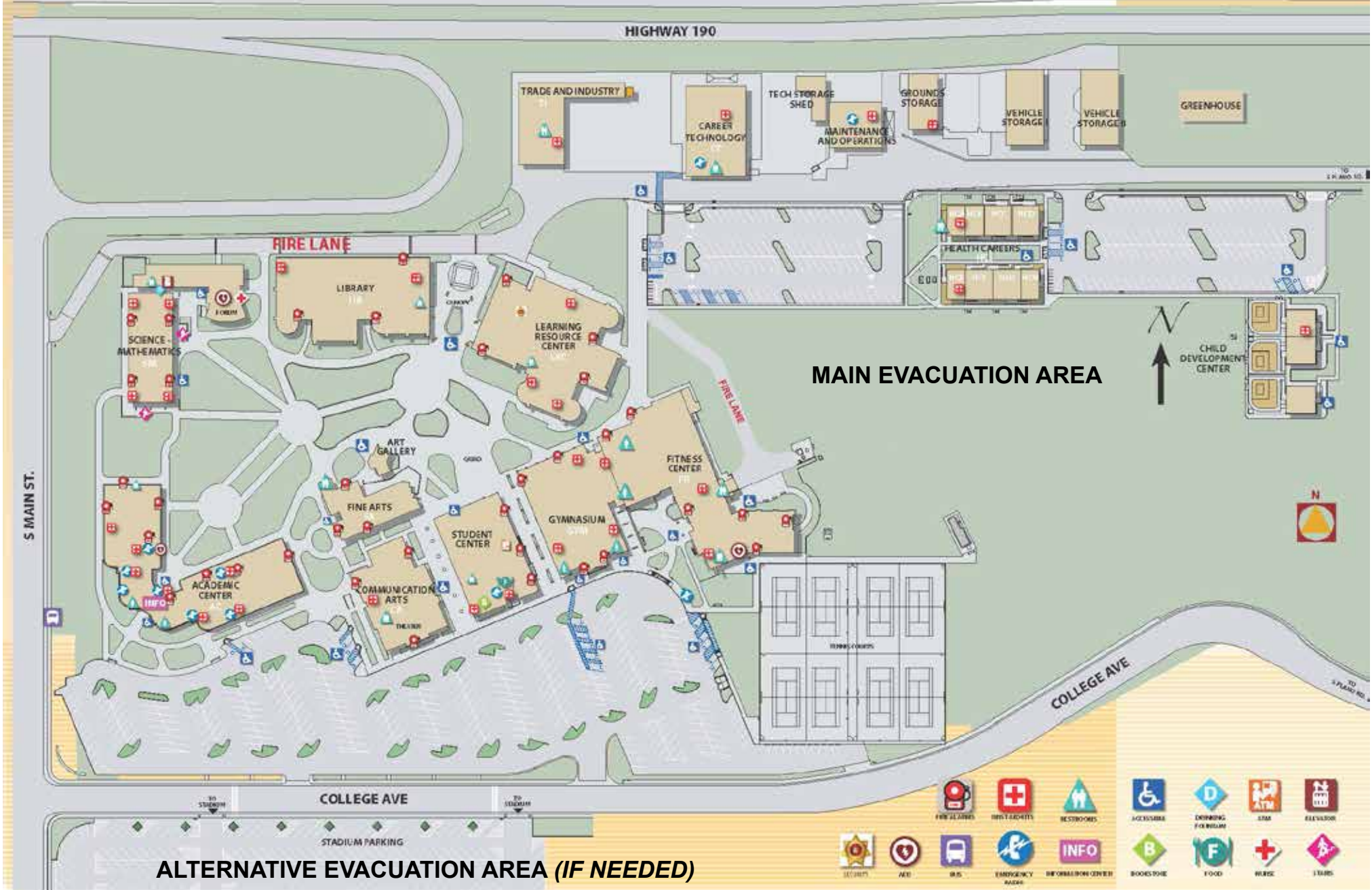

Porterville College

Campus Directory

Evacuation Area – Grassy area east of the Fitness Center

INJURIES (Students)

Under **NO** circumstance should you transport an injured or ill student to the hospital.
Call 9-911.

In the event a student is injured, **NO MATTER HOW SLIGHTLY**, notify the dean or administrator on duty. An Incident Report form must be completed and returned to Maintenance & Operations within 24 hours.

INJURIES (Employee)

Report all work-related injuries immediately (regardless of whether you require medical attention or not) to your supervisor or Dean and Human Resources. Work related injuries are covered by Workers' Compensation benefits, however, a delay in reporting could impact your claim. For more information on Workers' Compensation, contact Human Resources.

Emergency Telephone Numbers

Ambulance.....	9 - 911
Police.....	9 - 911
Fire.....	9 - 911
College Nurse.....	559-791-2212
Campus Security.....	559-310-2143
	559-791-2440
	559-791-2459
Instruction Office:	
Dean.....	559-791-2294
Associate Dean.....	559-791-2322
Vice Presidents:	
Instruction.....	559-791-2307
Student Services.....	559-791-2218
Switchboard (from on campus).....	0

PORTERVILLE
POLICE / FIRE DEPARTMENT:
782-7400